

Busbar supports

2017

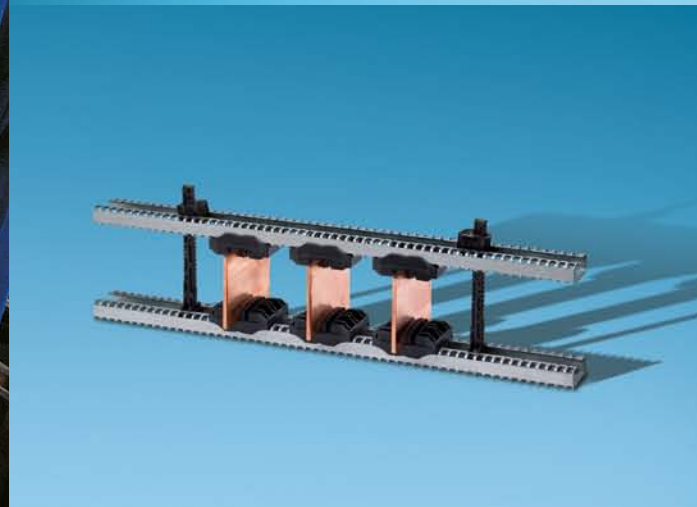

your energy
our expertise

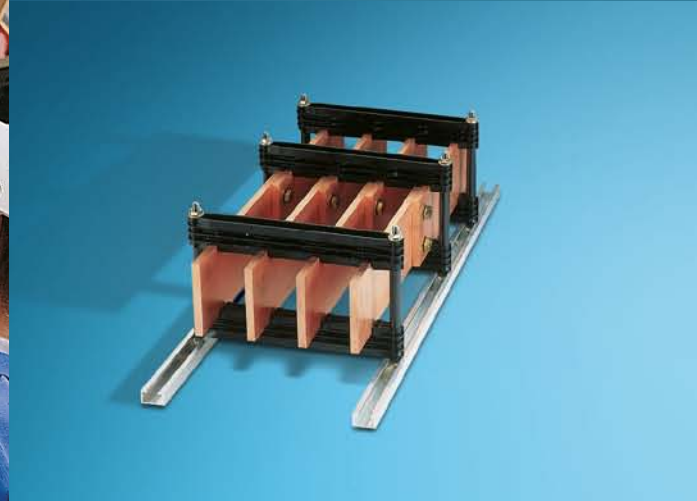
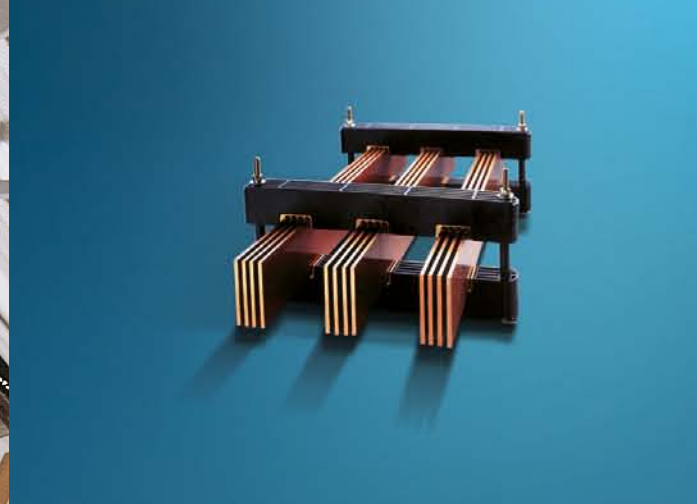



Busbar supports

Busbar

Enclosures
& accessories

new

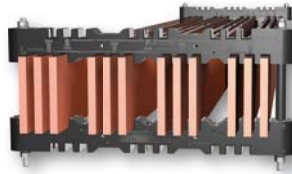

Fixed interphase, SB C 15

sb_214_a_1_cat.eps

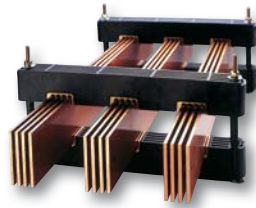

Busbar supports
with fixed interphase

sb_077_a_1_cat.eps

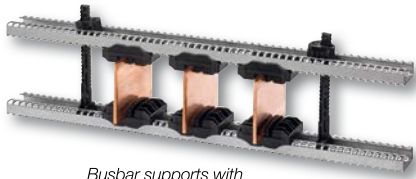

Busbar supports with
adjustable interphase

sb_195_a_1_cat.eps

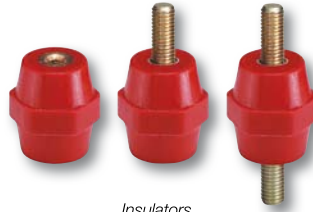

Insulators

sb_103_a_1_cat.eps

The solution for

- > Power distribution



Conformity to standards

- > IEC 61439-1
- > IEC 60865-1



Approvals and certifications⁽¹⁾

- > ASEFA/LCIE



Available on request

- > Please consult us

Function

SOCOMEK **insulating busbar supports** allow the fixation of a copper or aluminium bar or busbar.

Characteristics

Insulators

- Polyester without halogene.
- UL94 VO self-extinguishable.
- Colour red RAL 3002.
- Operating temperature from 40°C to + 130°C.
- Deformation under load temperature (ASTM D643): > 200 °C.
- Dielectric constant (ASTM D150): 4/5.
- Arc resistance (ASTM D495): > 180 s.
- Water absorption (ASTM D570): < 0.3 %.

Busbar support

- High dielectric strength.
- High mechanical resistance.
- Amagnetism of assembly parts.
- High resistance to damp heat (supplied "tropicalised").

Software tool for size selection

Mechanical systems is a software which is used to size bar sets. It defines the optimum busbar configuration depending on the electrical characteristics of the panel, in compliance with standard IEC 61439-1. It runs in a Windows® 95, 98, 2000, NT ou XP environment.

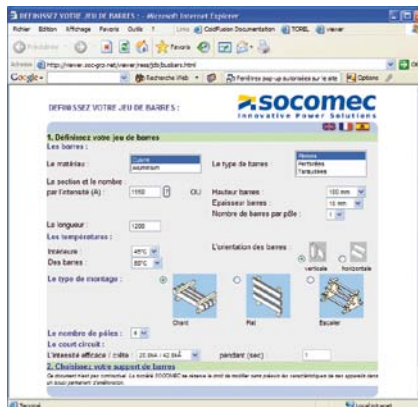

sb_201_b_1_fr_cat.eps

Selection guide

Edgewise mounting

• Busbar supports with **fixed interphase**

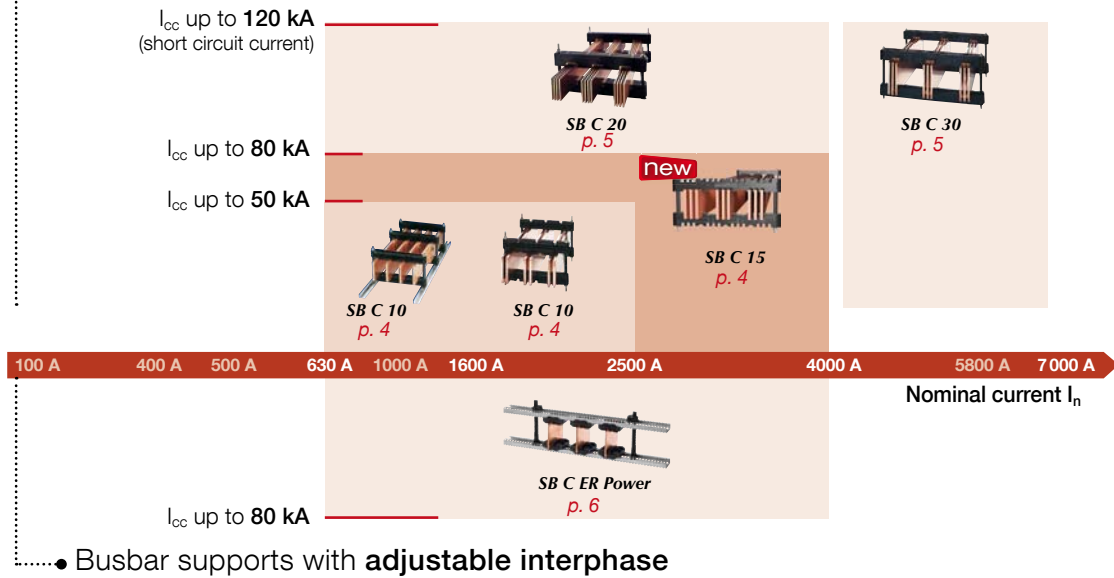

• Busbar supports with **adjustable interphase**

Flat mounting

• **Unipolar** busbar supports

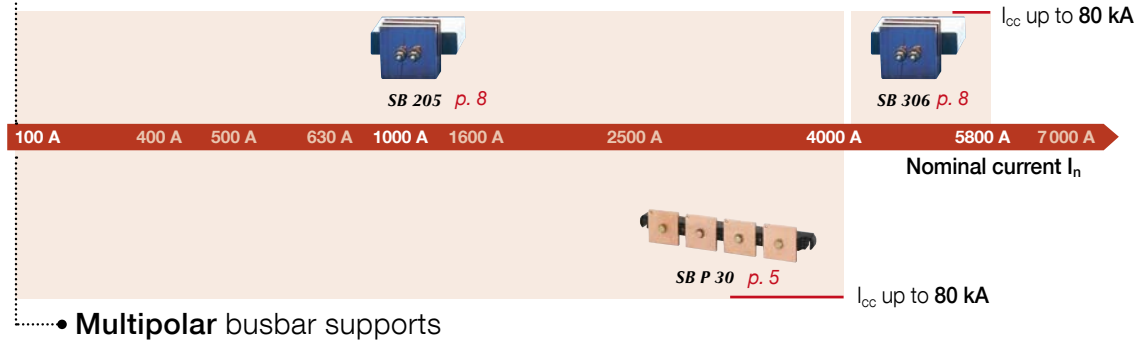

• **Multipolar** busbar supports

Other supports

• **Unipolar** busbar supports



Busbar supports

Busbar

Edgewise mounting busbar support fixed interphase

SB C 10

References

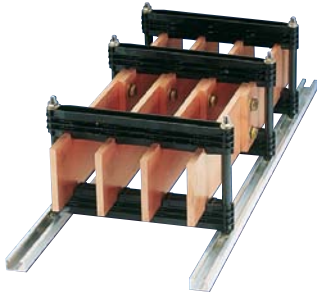

sb_061_b_2_cat.eps

No. of poles	No. of maximum bars	Reference
3	2x5 / 1x10	5024 6300
4	2x5 / 1x10	5024 6500
3	1x10 / 2x10	5024 6400
4	1x10 / 2x10	5024 6600

Characteristics

peak I _{sc}	3 & 4 poles with 5 mm bars						3 & 4 poles with 10 mm bars					
	15 kA	24 kA	48 kA	63 kA	82 kA	I _z (A)	15 kA	24 kA	48 kA	63 kA	82 kA	I _z (A)
rms I _{sc} (1s)	9 kA	12 kA	23 kA	30 kA	39 kA		9 kA	12 kA	23 kA	30 kA	39 kA	
Bars x no.	Max distance between 2 busbar supports (mm)											
25x1	775	475	225	175	140	330	1000	1000	500	375	275	
25x2	675	425	200	160	125	590	1000	1000	525	400	300	850
50x1	1000	700	350	250	200	600	1000	1000	725	550	425	850
50x2	1000	675	325	250	200	1050	1000	1000	800	600	475	1550
80x1	1000	950	475	350	225	900	1000	1000	975	725	550	1300
80x2	1000	975	475	375	275	1550	1000	1000	1000	850	650	2300
100x1	1000	1000	550	400	225	1100	1000	1000	1000	850	650	1550
100x2	1000	1000	575	425	325	1900	1000	1000	1000	975	675	2750

Dimensions

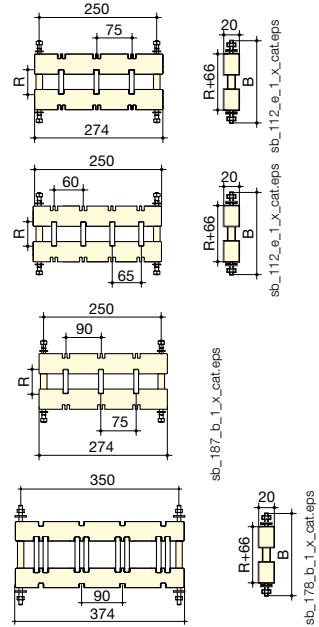

- Fixed interphase:
- 3 poles: 75 mm
 - 4 poles 5 mm: 60 mm
 - 4 poles 10 mm: 65 mm.
- Fixed interphase:
- 3 poles 1 x 10 mm: 75 mm
 - 3 poles 2 x 10 mm: 90 mm
 - 4 poles 1 or 2 x 10 mm: 90 mm.

SB C 15

References

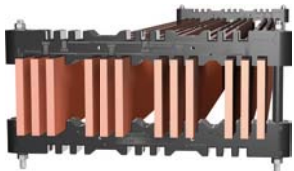

sb_214_a_1_cat.psd

No. of poles	No. of maximum bars	Bars thickness	Reference
3 / 4	1 ... 3	10	5024 4501

Characteristics

Characteristics of 3 and 4 poles with bars of 10 mm for SB C 15

peak I _{sc}	L max. (support bars in mm) for						D (mm)	I _z (A) ⁽¹⁾
	63 kA	82 kA	114 kA	152 kA	165 kA	176 kA		
rms I _{sc}	30 kA	39 kA	52 kA	69 kA	75 kA	80 kA		
Bar x qty								
40 x 10 x 1	1000	1000	600	225	200	200	90	700
40 x 10 x 2	1000	1000	600	225	200	200	90	1250
40 x 10 x 3	1000	1000	600	225	225	200	90	1800
50 x 10 x 1	1000	1000	600	225	200	200	90	850
50 x 10 x 2	1000	1000	600	225	200	200	90	1550
50 x 10 x 3	1000	1000	600	250	200	200	90	2150
80 x 10 x 1	1000	1000	600	275	225	225	90	1300
80 x 10 x 2	1000	1000	600	275	225	225	90	2300
80 x 10 x 3	1000	1000	600	275	225	225	90	3200
100 x 10 x 1	1000	1000	650	300	250	225	90	1550
100 x 10 x 2	1000	1000	650	300	250	225	90	2750
100 x 10 x 3	1000	1000	650	300	250	225	90	3250

(1) Admissible busbar nominal current with a temperature inside the panel of between 45°C and 80°C. For other mounting configurations, please contact us.

Dimensions

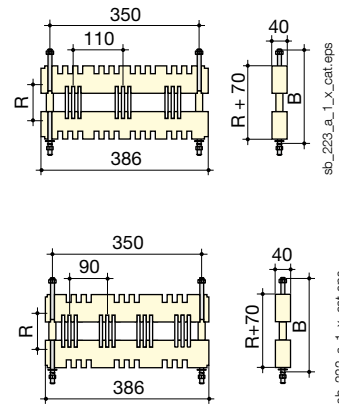

SB C 20

References

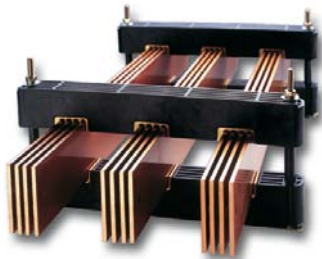

sb_077_a_1_cat.eps

No. of poles	No. of maximum bars	Bars thickness	Reference
3	1 ... 2	10	5024 7300
4	1 ... 2	10	5024 7400
3	1 ... 4	5	5024 8300
4	1 ... 4	5	5024 8400

Dimensions

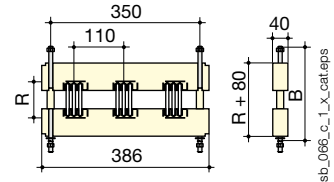

sb_066_c_1_x_cat.eps

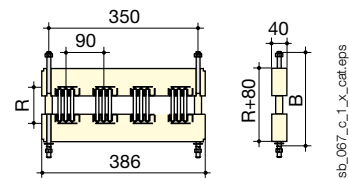

sb_067_c_1_x_cat.eps

Characteristics

peak I_{sc}	3 & 4 poles with 5 mm bars						3 & 4 poles with 10 mm bars					
	63 kA	82 kA	114 kA	152 kA	165 kA	I_z (A)	63 kA	82 kA	114 kA	152 kA	165 kA	I_z (A)
rms I_{sc} (1s)	30 kA	39 kA	52 kA	69 kA	75 kA		30 kA	39 kA	52 kA	69 kA	75 kA	
Bars x no.	Max distance between 2 busbar supports (mm)											
50x1	625	475	350	250	225	600	1000	925	675	500	450	850
50x2	525	400	300	225	200	1050	1000	850	600	450	400	1550
80x1	800	625	450	325	300	900	1000	1000	850	625	575	1300
80x2	725	550	400	300	275	1550	1000	1000	775	575	525	2300
100x1	900	700	500	375	350	1100	1000	1000	950	700	650	1550
100x2	850	650	475	350	325	1900	1000	1000	850	625	575	2750
125x1	1000	800	575	425	400	1300	1000	1000	1000	800	725	1900
125x2	975	750	550	400	375	2350	1000	1000	925	675	625	3350

- Fixed interphase:
- 3 poles: 110 mm
 - 4 poles: 90 mm

SB C 30

References



sb_173_a_2_cat

No. of poles	No. of maximum bars	Bars thickness	Reference
3	1 ... 3	10	5024 5300
4	1 ... 3	10	5024 5500

Dimensions

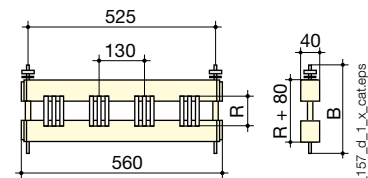

sb_157_d_1_x_cat.eps

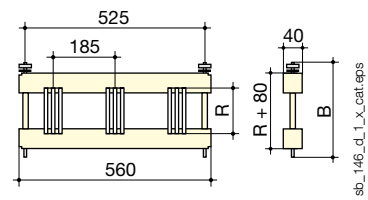

sb_146_d_1_x_cat.eps

Characteristics

peak I_{sc}	3 & 4 poles with 5 mm bars							
	82 kA	114 kA	152 kA	165 kA	187 kA	220 kA	264 kA	I_z (A)
rms I_{sc} (1s)	39 kA	52 kA	69 kA	75 kA	85 kA	100 kA	120 kA	
Bars x no.	Max distance between 2 busbar supports (mm)							
80x1	1000	1000	750	675	600	500	425	1300
80x2	1000	825	625	575	500	425	350	2300
80x3	750	550	400	375	325	275	225	3200
125x1	1000	1000	925	850	750	625	525	1900
125x2	1000	1000	750	675	600	500	425	3350
125x3	1000	750	550	525	450	375	325	4650
160x1	1000	1000	1000	925	825	700	575	2350
160x2	1000	1000	750	700	625	525	425	4150
160x3	1000	900	675	625	550	475	375	5800

- Fixed interphase:
- 3 poles: 185 mm
 - 4 poles: 130 mm

Busbar supports

Busbar

Edgewise mounting busbar support fixed interphase

■ Stud kits for **SB C 10, 15, 20 & 30**

References

Bar width	Available for	B SBC 10	B SBC 15	B SBC 20	B SBC 30	Reference
25	SBC 10	160	-	-	-	5020 2025
30	SBC 10 ; SBC 15	160	160	-	-	5020 2030
40	SBC 10 ; SBC 15	160	160	-	-	5020 2040
50	SBC 10 ; SBC 15 ; SBC 20 ; SBC 30	190	190	190	190	5020 2050
60	SBC 10 ; SBC 15 ; SBC 20 ; SBC 30	190	190	190	190	5020 2060
63	SBC 10 ; SBC 20 ; SBC 30	190	-	190	190	5020 2063
70	SBC 30	-	-	-	190	5020 2070
80	SBC 10 ; SBC 15 ; SBC 20 ; SBC 30	220	220	220	220	5020 2080
100	SBC 10 ; SBC 15 ; SBC 20 ; SBC 30	220	220	220	220	5020 2100
120	SBC 20	-	-	245	-	5020 2120
125	SBC 15 ; SBC 20 ; SBC 30	-	245	245	245	5020 2125
160	SBC 15 ; SBC 20 ; SBC 30	-	280	280	280	5020 2160
200	SBC 20 ; SBC 30	-	-	-	325	5020 2200

Order example for a SBC 20 4 poles 2 x 60 x 10: 1 x 5024 7400 + 1 x 5020 2060.

Edgewise mounting busbar support adjustable interphase

■ **SB C ER P**

References

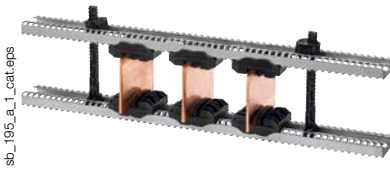

No. of poles	No. of bars	Bars thickness	Order quantity for 1 support	Reference
3	1...3	5	6	5025 5205
4	1...3	5	8	5025 5205
3	1...2	10	6	5025 5210
4	1...2	10	8	5025 5210
3	1...3	10	6	5025 5111
4	1...3	10	8	5025 5111

Dimensions

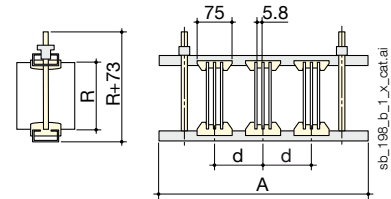

5 mm insert / 3 bars

Accessories

Description	Length	Order quantity for 1 support	Reference
Rod kit (bar height 25 to 200 mm)		2	5025 5100
380 mm profile	380	2	5025 5124
480 mm profile	480	2	5025 5125
580 mm profile	580	2	5025 5126
780 mm profile	780	2	5025 5128
2 m profile	2000		5025 5120

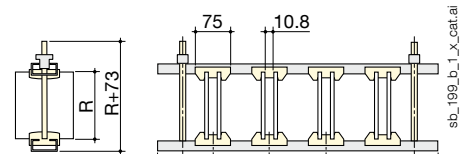

10 mm insert / 2 bars

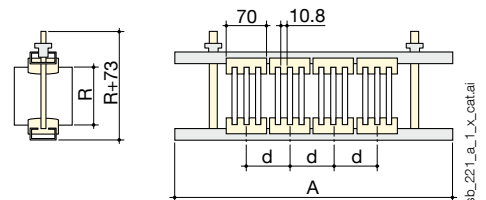

10 mm insert / 3 bars

A (mm)	Enclosure (mm)
380	400
480	500
580	600
780	800

Edgewise mounting busbar support adjustable interphase (continued)

■ SB C ER P

Characteristics

5 mm inserts for up to 3 bars and 10 mm inserts for up to 2 bars

peak I_{sc}	L max. (support bars in mm) for					d min. (mm)	Iz (A) ⁽¹⁾
	82 kA	114 kA	152 kA	165 kA	187 kA		
rms I_{sc}	39 kA	52 kA	69 kA	75 kA	85 kA		
Bar x qty							
50 x 5 x 1	500	325	175	150		75	600
50 x 5 x 2	500	325	175	150	100	75	1050
50 x 5 x 3	500	325	175	150	100	75	1450
63 x 5 x 1	525	350	200	175		75	700
63 x 5 x 2	525	350	200	175	125	75	1250
63 x 5 x 3	525	350	200	175	125	75	1800
80 x 5 x 1	525	350	200	175	125	75	900
80 x 5 x 2	525	350	200	175	125	75	1550
80 x 5 x 3	525	350	200	175	125	75	2200
100 x 5 x 1	550	375	225	200	175	75	1100
100 x 5 x 2	550	375	225	200	175	75	1900
100 x 5 x 3	550	375	225	200	175	75	2650
125 x 5 x 1	575	400	250	225	200	75	1300
125 x 5 x 2	575	400	250	225	200	75	2350
125 x 5 x 3	575	400	250	225	200	75	3250
80 x 10 x 1	1000	750	350	300	200	75	1300
80 x 10 x 2	1000	750	350	300	200	75	2300
100 x 10 x 1	1000	750	375	325	225	75	1550
100 x 10 x 2	1000	775	375	325	225	75	2750
125 x 10 x 1	1000	775	375	325	225	75	1900
125 x 10 x 2	1000	775	375	325	225	75	3350
160 x 10 x 1	1000	775	400	350	250	75	2350
160 x 10 x 2	1000	800	400	350	250	75	4150

(1) Admissible busbar nominal current with a temperature inside the panel of between 45°C and 80°C.
For other mounting configurations, please contact us.

10 mm insert / 3 bars

peak I_{sc}	L max. (bar supports in mm)						D (mm)	Iz (A) ⁽¹⁾
	63 kA	82 kA	114 kA	152 kA	165 kA	187 kA		
rms I_{sc}	30 kA	39 kA	52 kA	69 kA	75 kA	85 kA		
Bar x qty								
50 x 10 x 1	1000	1000	650	250	200	150	70	850
50 x 10 x 2	1000	1000	650	250	200	150	70	1550
50 x 10 x 3	1000	1000	650	250	200	150	70	2150
63 x 10 x 1	1000	1000	675	275	225	175	70	1050
63 x 10 x 2	1000	1000	675	275	225	175	70	1850
63 x 10 x 3	1000	1000	675	275	225	175	70	2600
80 x 10 x 1	1000	1000	700	300	250	175	70	1300
80 x 10 x 2	1000	1000	700	300	250	175	70	2300
80 x 10 x 3	1000	1000	700	300	250	175	70	3200
100 x 10 x 1	1000	1000	725	325	275	175	70	1550
100 x 10 x 2	1000	1000	725	325	275	175	70	2750
100 x 10 x 3	1000	1000	725	325	275	175	70	3250
125 x 10 x 1	1000	1000	725	350	275	200	70	1900
125 x 10 x 2	1000	1000	725	350	275	200	70	3350
125 x 10 x 3	1000	1000	725	350	275	200	70	4650
160 x 10 x 1	1000	1000	750	350	300	200	70	2350
160 x 10 x 2	1000	1000	750	350	300	200	70	4150
160 x 10 x 3	1000	1000	750	350	300	200	70	5800

(1) Admissible busbar nominal current with a temperature inside the panel of between 45°C and 80°C.
For other mounting configurations, please contact us.

Busbar supports

Busbar

Unipolar flat mounting busbar support

SB 205 - SB 306

References

sb_117_a_1_cat.eps

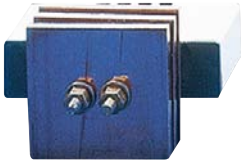

Support	Insulation voltage (VAC)	No. of bars	Bar width (mm)	To be ordered in multiples of	Reference
SB 205	1000	1 ... 3	100	6	5022 5110
SB 306	1000	1 ... 3	160	6	5023 6110

Dimensions

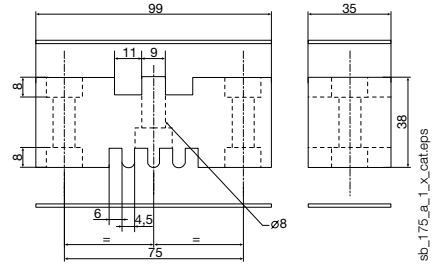

sb_175_a_1_x_cat.eps

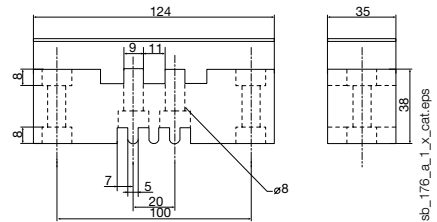

sb_176_a_1_x_cat.eps

Characteristics

Support	Bars x no.	Max. L (distance between centres of supports in mm) for						d min. (mm)	Iz (A) ⁽¹⁾	
		peak I _{sc}	48 kA	63 kA	82 kA	114 kA	152 kA			165 kA
		rms I _{sc}	23 kA	30 kA	39 kA	52 kA	69 kA			75 kA
SB 205	100 x 10 x 1	1000	1000	1000	1000	1000	1000	125	1550	
SB 205	100 x 10 x 2	1000	1000	1000	1000	1000	1000	125	2750	
SB 205	100 x 10 x 3	1000	1000	1000	1000	1000	1000	125	3850	
SB 306	160 x 10 x 1	1000	1000	1000	1000	1000	1000	175	2350	
SB 306	160 x 10 x 2	1000	1000	1000	1000	1000	1000	175	4150	
SB 306	160 x 10 x 3	1000	1000	1000	1000	1000	1000	175	5800	

(1) Admissible nominal current for a temperature in the cabinet of 45°C and 80°C for the bars.
Other assembly configurations: please consult us.

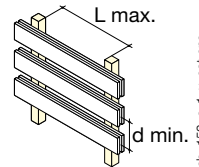
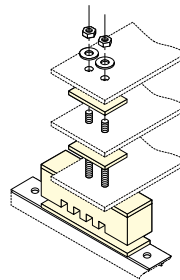

sb_152_a_1_x_cat.eps

Mounting

- SB 205: 1 to 3 bars of max. width 100 mm.
- SB 306: 1 to 3 bars of max. width 160 mm.

Multipolar flat mounting busbar supports with fixed interphase

SB P 30

References

No. of poles	Insulation voltage (VAC)	Bar width (mm)	Pack qty	Reference
3	1000	50-100	1	5023 0310
4	1000	50-80	1	5023 0410

Mounting bracket		To be ordered in multiples of	Reference
Description of accessories			
2 mounting brackets for SB P 30		1	5024 9002

Bar fixing screws		To be ordered in multiples of	Reference
Description of accessories			
Headless screw for attaching 1 thickness of bar		25	5119 4601
Headless screw for attaching 2 thicknesses of bar		25	5119 4602
Headless screw for attaching 3 thicknesses of bar		25	5119 4603

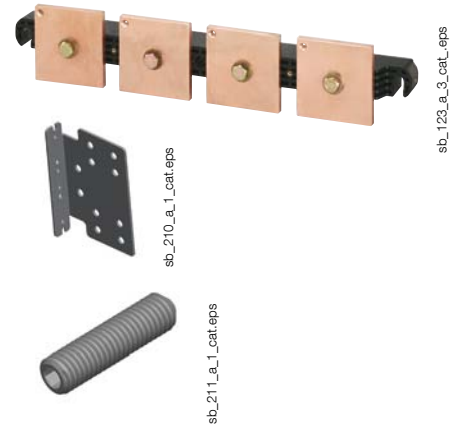

Characteristics

d = 123 mm

peak I _{sc}	Max. L (distance between centres of supports in mm) for								d (mm)	Iz (A)
	63 kA	84 kA	110 kA	143 kA	165 kA	176 kA	187 kA	220 kA		
rms I _{sc}	30 kA	40 kA	50 kA	65 kA	75 kA	80 kA	85 kA	100 kA		
Bars x no.										
50 x 5 x 1	1000	950	525	300	225	200	175	130	123	600
63 x 5 x 1	1000	925	525	300	225	200	175	130	123	700
80 x 5 x 1	1000	900	500	300	225	175	175	125	123	900
80 x 5 x 2	1000	900	500	300	225	175	175	125	123	1 550
50 x 10 x 1	1000	950	525	300	225	200	175	130	123	850
50 x 10 x 2	1000	975	525	300	225	200	175	135	123	1 550
63 x 10 x 1	1000	925	525	300	225	200	175	130	123	1 050
63 x 10 x 2	1000	950	525	300	225	200	175	130	123	1 850
80 x 10 x 1	1000	900	500	300	225	175	175	125	123	1 300
80 x 10 x 2	1000	925	500	300	225	200	175	125	123	2 300
80 x 10 x 3	1000	950	525	300	225	200	175	130	123	3 200

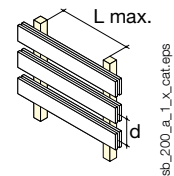
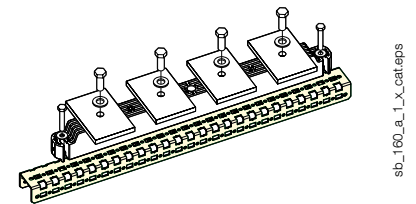

peak I _{sc}	Max. L (distance between centres of supports in mm) for								d (mm)	Iz (A)
	63 kA	84 kA	110 kA	143 kA	165 kA	176 kA	187 kA	220 kA		
rms I _{sc}	30 kA	40 kA	50 kA	65 kA	75 kA	80 kA	85 kA	100 kA		
Bars x no.										
50 x 5 x 1	1000	1000	800	475	350	300	275	200	185	
63 x 5 x 1	1000	1000	800	475	350	300	275	200	185	
80 x 5 x 1	1000	1000	800	475	350	300	275	200	185	
80 x 5 x 2	1000	1000	800	475	350	300	275	200	185	
100 x 5 x 1	1000	1000	775	450	325	300	250	175	185	1100
100 x 5 x 2	1000	1000	775	450	325	300	250	175	185	1900
100 x 5 x 3	1000	1000	775	450	350	300	250	175	185	2650
50 x 10 x 1	1000	1000	800	475	350	300	275	200	185	
50 x 10 x 2	1000	1000	800	475	350	300	275	200	185	
63 x 10 x 1	1000	1000	800	475	350	300	275	200	185	
63 x 10 x 2	1000	1000	800	475	350	300	275	200	185	
80 x 10 x 1	1000	1000	800	475	350	300	275	200	185	
80 x 10 x 2	1000	1000	800	475	350	300	275	200	185	
80 x 10 x 3	1000	1000	800	475	350	300	275	200	185	
100 x 10 x 1	1000	1000	775	450	325	300	250	175	185	1550
100 x 10 x 2	1000	1000	775	450	350	300	250	175	185	2750
100 x 10 x 3	1000	1000	775	450	350	300	275	175	185	3850

Mounting

- 3 poles: 1 to 3 bars of max. width 100 mm per pole, fixed interphase of 185 mm,
- 4 poles: 1 to 3 bars of max. width 80 mm per pole, fixed interphase of 123 mm.

Dimensions

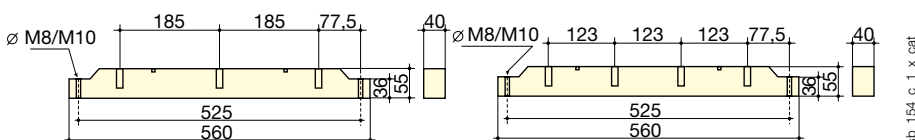

Busbar supports

Busbar

Unipolar flat mounting busbar support

Female to female **hexagonal insulator**

References



sb_104_g_1_cat.eps

Height (mm)	Insert	Depth (mm)		Ø (mm)		Pack	Reference
H	M	P	Pu	E		qty	
20	M4	8	5,5	19		1	5031 2004
20	M6	8	5,5	19		1	5031 2006
25	M6	10	7	21		1	5031 2506
30	M6	10	7	33		1	5031 3006
30	M8	12	9	33		1	5031 3008
35	M6	12	9	33		1	5031 3506
35	M8	12	9	33		1	5031 3508
35	M10	12	9	33		1	5031 3510
40	M8	15	12	40		1	5031 4008
40	M10	15	12	40		1	5031 4010
45	M8	15	12	41		1	5031 4508
45	M10	15	12	41		1	5031 4510
50	M8	20	17	46		1	5031 5008
50	M10	20	17	46		1	5031 5010
50	M12	20	17	46		1	5031 5012
60	M10	20	17	50		1	5031 6010
65	M10	20	17	55		1	5031 6510
70	M12	25	21	55		1	5031 7012

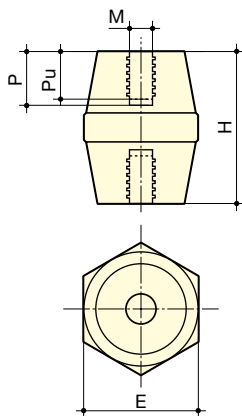

sb_105_g_1_x_cat.eps

Headless screw

References

Length (mm)	Thread	To be ordered in multiples of	Reference
20	M6	20	5032 2006
20	M8	20	5032 2008
25	M6	20	5032 2506
25	M8	20	5032 2508
30	M6	20	5032 3006
30	M8	20	5032 3008
40	M8	20	5032 4008
40	M10	20	5032 4010
50	M12	20	5032 5012



sb_121_g_2_cat.eps

Characteristics

H (mm)	Insert M	Bars x no.	Max. L (distance between centres of supports in mm) for						d min. (mm)	Iz (A) ⁽¹⁾	
			peak I _{sc}	24 kA		48 kA		114 kA			
			rms I _{sc}	12 kA	23 kA	30 kA	39 kA	52 kA			
20	M4	15 x 5 x 1	400	100				45	220		
20	M4	20 x 5 x 1	400	100				45	280		
25	M6	15 x 5 x 1	550	135				45	220		
25	M6	20 x 5 x 1	525	135				45	280		
25	M6	25 x 5 x 1	575	145				50	330		
30	M6	15 x 5 x 1	675	165				45	220		
30	M6	20 x 5 x 1	650	165				45	280		
30	M6	25 x 5 x 1	725	175	105			50	330		
30	M8	15 x 5 x 1	850	250	155			45	220		
30	M8	20 x 5 x 1	1000	250	155			45	280		
30	M8	25 x 5 x 1	1000	275	170	100		50	330		
35	M6	15 x 5 x 1	700	175	100			45	220		
35	M6	20 x 5 x 1	675	170	100			45	280		
35	M6	25 x 5 x 1	750	175	110			50	330		
35	M8	15 x 5 x 1	850	275	160			45	220		
35	M8	20 x 5 x 1	1000	275	160			45	280		
35	M8	25 x 5 x 1	1000	300	175	105		50	330		
35	M8	32 x 5 x 1	1000	325	175	110		55	410		
35	M10	20 x 5 x 1	850	200	125			45	280		
35	M10	25 x 5 x 1	950	225	135			50	330		
35	M10	32 x 5 x 1	1000	250	150			55	410		
40	M8	20 x 5 x 1	1000	325	175	110		45	280		
40	M8	25 x 5 x 1	1000	350	200	125		50	330		
40	M8	32 x 5 x 1	1000	375	225	135		55	410		
40	M10	20 x 5 x 1	1000	325	175	110		45	280		
40	M10	25 x 5 x 1	1000	350	200	125		50	330		
40	M10	32 x 5 x 1	1000	375	225	135		55	410		
45	M8	25 x 5 x 1	1000	425	250	150		50	330		
45	M8	32 x 5 x 1	1000	475	175	160		55	410		
45	M8	50 x 5 x 1	1000	625	350	200	110	75	600		
45	M10	25 x 5 x 1	1000	425	250	145		50	330		
45	M10	32 x 5 x 1	1000	450	250	160		55	410		
45	M10	50 x 5 x 1	1000	600	350	200	110	75	600		
50	M8	25 x 5 x 1	1000	450	250	155		50	330		
50	M8	32 x 5 x 1	1000	475	275	170		55	410		
50	M8	50 x 5 x 1	1000	650	375	225	115	75	600		
50	M10	32 x 5 x 1	1000	525	300	175		55	410		
50	M10	50 x 5 x 1	1000	700	400	225	125	75	600		
60	M10	50 x 5 x 1	1000	700	400	225	125	75	600		
65	M10	50 x 5 x 1	1000	775	450	250	135	75	600		

(1) Admissible nominal current for a temperature in the cabinet of 45°C and 80°C for the bars.

Other assembly configurations: please consult us.

Model: SOCOMEC
Production: SOCOMEC
Photography: Martin Bernhart en Studio Objectif

Socomec worldwide

IN EUROPE

BELGIUM

Critical Power / Power Control & Safety / Energy Efficiency

Tel. +32 2 340 02 30
Fax +32 2 346 28 99
info.be@socomec.com

FRANCE

Critical Power / Power Control & Safety / Energy Efficiency

Tel. +33 1 45 14 63 00
Fax +33 1 48 67 31 12
dcm.ups.fr@socomec.com

GERMANY

Critical Power

Tel. +49 621 71 68 40
Fax +49 621 71 68 444
info.ups.de@socomec.com

Power Control & Safety / Energy Efficiency

Tel. +49 7243 65292 0
Fax +49 7243 65292 13
info.scp.de@socomec.com

ITALY

Critical Power

Tel. +39 02 98 242 942
Fax +39 02 98 240 723
info.ups.it@socomec.com

Power Control & Safety / Energy Efficiency

Tel. +39 02 98 49 821
Fax +39 02 98 24 33 10
info.scp.it@socomec.com

NETHERLANDS

Critical Power / Power Control & Safety / Energy Efficiency

Tel. +31 30 760 0900
Fax +31 30 637 2166
info.nl@socomec.com

POLAND

Critical Power

Tel. +48 22 825 73 60
Fax. +48 22 825 73 70
info.ups.pl@socomec.com

Power Control & Safety / Energy Efficiency

Tel. +48 91 442 64 11
Fax +48 91 442 64 19
info.scp.pl@socomec.com

PORTUGAL

Critical Power / Power Control & Safety / Energy Efficiency

Tel. +351 261 812 599
Fax +351 261 812 570
info.ups.pt@socomec.com

ROMANIA

Critical Power / Power Control & Safety / Energy Efficiency

Tel. +40 21 319 36 88
Fax +40 21 319 36 89
info.ro@socomec.com

SERBIA

Critical Power / Power Control & Safety / Energy Efficiency

Tel. +381 11 40 43 246
Fax +381 11 40 43 245
info.rs@socomec.com

SLOVENIA

Critical Power / Power Control & Safety / Energy Efficiency

Tel. +386 1 5807 860
Fax +386 1 561 11 73
info.si@socomec.com

SPAIN

Critical Power / Power Control & Safety / Energy Efficiency

Tel. +34 93 540 75 75
Fax +34 93 540 75 76
info.es@socomec.com

SWITZERLAND

Critical Power

Tel. +41 44 745 40 80
Fax +41 44 745 40 85
info@socomec.ch

TURKEY

Critical Power / Power Control & Safety / Energy Efficiency

Tel. +90 216 540 71 20-21-22
Fax +90 216 540 71 27
info.tr@socomec.com

UNITED KINGDOM

Critical Power

Tel. +44 1285 863 300
Fax +44 1285 862 304
info.uk@socomec.com

Power Control & Safety / Energy Efficiency

Tel. +44 1462 440 033
Fax +44 1462 431 143
info.uk@socomec.com

IN ASIA PACIFIC

AUSTRALIA

Critical Power / Power Control & Safety

Tel. +61 2 9325 3900
Fax +61 2 9888 9544
info.ups.au@socomec.com

CHINA

Critical Power / Power Control & Safety / Energy Efficiency

Tel. +86 21 52 98 95 55
Fax +86 21 62 28 34 68
info.cn@socomec.com

INDIA

Critical Power / Power Control & Safety / Energy Efficiency

Tel. +91 44 39215400
Fax +91 44 39215450 & 51
info.in@socomec.com

SINGAPORE

Critical Power / Power Control & Safety / Energy Efficiency

Tel. +65 6506 7600
Fax +65 64 58 7377
info.sg@socomec.com

THAILAND

Critical Power

Tel. +66 2 941 1644 7
Fax +66 2 941 1650
info.ups.th@socomec.com

IN MIDDLE EAST

UNITED ARAB EMIRATES

Critical Power / Power Control & Safety / Energy Efficiency

Tel. +971 4 29 98 441
Fax +971 4 29 98 449
info.ae@socomec.com

IN AMERICA

USA, CANADA & MEXICO

Power Control & Safety / Energy Efficiency

Tel. +1 617 245 0447
Fax +1 617 245 0437
info.us@socomec.com

OTHER COUNTRIES

NORTH AFRICA

Algeria / Morocco / Tunisia
info.naf@socomec.com

AFRICA

Other countries
info.africa@socomec.com

SOUTH EUROPE

Cyprus / Greece / Israel / Malta
info.se@socomec.com

SOUTH AMERICA

Tel. +34 93 540 75 75
info.es@socomec.com

MORE DETAILS

www.socomec.com/worldwide

HEAD OFFICE

SOCOMECC GROUP

SAS SOCOMECC capital 10 686 000 €
R.C.S. Strasbourg B 548 500 149
B.P. 60010 - 1, rue de Westhouse
F-67235 Benfeld Cedex - FRANCE
Tel. +33 3 88 57 41 41
Fax +33 3 88 74 08 00
info.scp.isd@socomec.com

www.socomec.com

YOUR DISTRIBUTOR / PARTNER

your energy
our expertise

